



PRINTED COPIES OF THIS DOCUMENT ARE FOR "REFERENCE" ONLY. CURRENT REVISIONS ARE AVAILABLE ONLINE.

HEAD MARKING

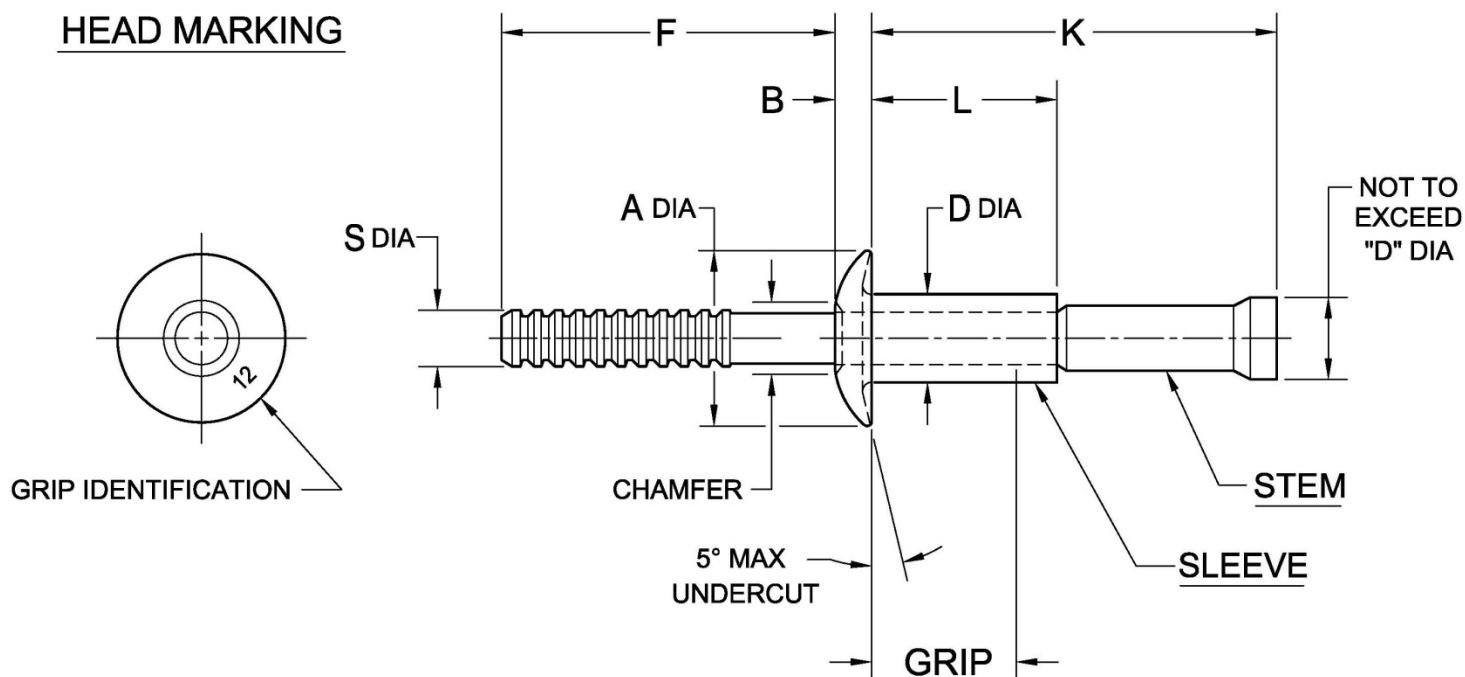

TABLE I

DIA. DASH NO.	A	B +.010 -.000	D +.003 -.001	F MIN	S ±.003
-4	.238-.262	.054	.134	.750	.086
-5	.296-.328	.067	.172		.108
-6	.356-.394	.080	.202		.127
-8	.475-.525	.107	.268	1.000	.170

TABLE II

FINISH CODE	MATERIAL (4)		FINISH	
	SLEEVE	STEM	SLEEVE	STEM
---	2117 ALUMINUM PER QQ-A-430	2017 ALUMINUM PER QQ-4-430	ANODIZE PER MIL-A-8625 BLUE COLOR	CHEM. FILM PER MIL-DTL-5541
G (3)			CHEM. FILM PER MIL-DTL-5541 CL 1A, TYPE II BLUE COLOR	CHEM. FILM PER MIL-DTL-5541 CL 1A, TYPE II

NOTICE: ALL DIMENSIONS ARE IN INCHES AND APPLY AFTER FINISH AND BEFORE LUBRICATION UNLESS OTHERWISE SPECIFIED.

WARNING: FASTENERS MAY NOT PERFORM PROPERLY IF ALTERED FROM THE MANUFACTURER'S AS-SHIPPED CONDITION OR INSTALLED IN CONDITIONS OTHER THAN SPECIFIED HEREIN.

PROCUREMENT SPECIFICATION:

CHERRY® MS RIVET
SERRATED STEM, SELF-PLUGGING
UNIVERSAL HEAD

SHEET 1 OF 2

PART NUMBER

NAS 523 CODE:

ISSUE

01-25-77

REV.

K

5-14-15

CR9179

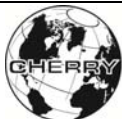

TABLE III

GRIP DASH NO.	GRIP RANGE ①		-4 DIA		-5 DIA		-6 DIA		-8 DIA	
			L	K	L	K	L	K	L	K
	MIN	MAX	MAX	MAX	MAX	MAX	MAX	MAX	MAX	MAX
-01	②	.062	.170	.500	.192	.558	.215	.638	---	---
-02	.063	.125	.232	.600	.254	.620	.277	.700	.322	.850
-03	.126	.187	.295	.750	.317	.808	.340	.888	.385	.970
-04	.188	.250	.357	.850	.379	.870	.402	.950	.447	1.090
-05	.251	.312	.420	1.010	.441	1.058	.465	1.138	.510	1.220
-06	.313	.375	.482	1.100	.503	1.120	.527	1.200	.572	1.340
-07	.376	.437	.545	1.197	.567	1.339	.590	1.419	.635	1.470
-08	.438	.500	.607	1.322	.629	1.401	.652	1.481	.697	1.590
-09	.501	.562	.670	1.509	.692	1.567	.715	1.637	.760	1.720
-10	.563	.625	.722	1.600	.754	1.630	.777	1.699	.822	1.840
-11	.626	.687	.785	1.730	.817	1.817	.840	1.887	.885	1.970
-12	.688	.750	.847	1.820	.879	1.880	.902	1.949	.947	2.090
-13	.751	.812	---	---	.942	2.067	.965	2.074	1.010	2.220
-14	.813	.875	---	---	---	---	---	---	1.072	2.340

NOTES:

- ① MAY ALSO BE USED IN 1/64 THICKER GRIP.
- ② MINIMUM GRIP FOR -4 DIAMETER IS .025; FOR -5 DIAMETER IS .031; FOR -6 DIAMETER IS .037.
- ③ FINISH CODES WITH THE PREFIX "G" INDICATE REACH COMPLIANT COATING.
- ④ MATERIAL DESIGNATION REFERS TO CHEMICAL COMPOSITION ONLY.

EXAMPLE OF CHERRY PART NUMBER:

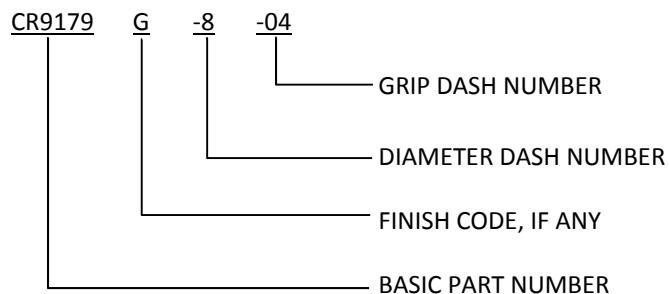

SHEET 2 OF 2		PART NUMBER	
ISSUE	01-25-77	CR9179	
REV.	K 5-14-15		

STANDARDS PAGE REVISION LOG CR9179

REV LTR	DATE	DCR NUMBER	REVISION DESCRIPTION	COMP. BY
K	14 May-15	14-1283	<ul style="list-style-type: none">• ADDED REACH COMPLIANT COATING G• ADDED NOTE 3• GENERAL CLEANUP AND STANDARDIZATION	CL