



PRINTED COPIES OF THIS DOCUMENT ARE FOR "REFERENCE" ONLY. CURRENT REVISIONS ARE AVAILABLE ONLINE.

HEAD MARKING

GRIP IDENTIFICATION NOT
REQUIRED FOR -3 DIAMETER



GRIP IDENTIFICATION

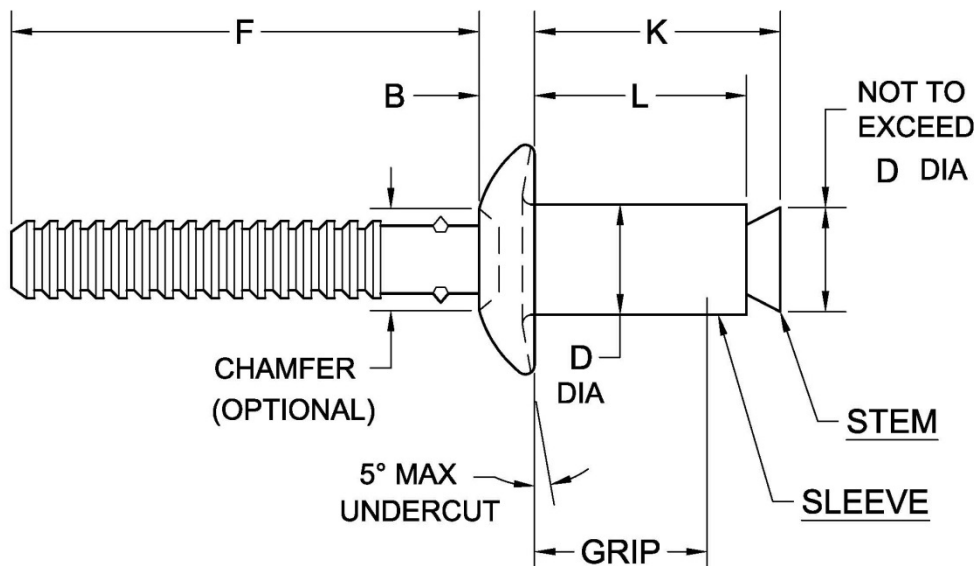

TABLE I

DIA. DASH NO.	A	B +.010 -.000	D +.003 -.001	F MIN
-3	.178-.196	.040	.094	.750
-4	.238-.262	.054	.125	
-5	.296-.328	.067	.156	
-6	.356-.394	.080	.187	
-8	.465-.535	.107	.250	1.000

NOTICE: ALL DIMENSIONS ARE IN INCHES AND APPLY AFTER FINISH AND BEFORE LUBRICATION UNLESS OTHERWISE SPECIFIED.

WARNING: FASTENERS MAY NOT PERFORM PROPERLY IF ALTERED FROM THE MANUFACTURER'S AS-SHIPPED CONDITION OR INSTALLED IN CONDITIONS OTHER THAN SPECIFIED HEREIN.

PROCUREMENT SPECIFICATION:

NASM8814

NAS 523 CODE:

CHERRY® MS RIVET
SERRATED STEM, PULL-THROUGH
UNIVERSAL HEAD

SHEET 1 OF 3

PART NUMBER

ISSUE

12-30-77

REV.

AA

5-14-15

CR9117

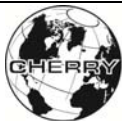

TABLE II

FINISH CODE	MATERIAL ①		FINISH	
	SLEEVE	STEM	SLEEVE	STEM
---	2117 ALUMINUM PER QQ-A-430	STEEL PER ASTM A510	CHEM. FILM PER MIL-DTL-5541 CL 1A	AS REQUIRED FOR CORROSION PROTECTION
PR ⑥				
V			ANODIZE PER MIL-A-8625 TYPE I, CL 1	
G ⑧			CHEM. FILM PER MIL-DTL-5541 CL 1A, TYPE II	
GPR ⑥⑧				

TABLE III

GRIP DASH NO.	GRIP RANGE				-3 DIA		-4 DIA		-5 DIA		-6 DIA		-8 DIA	
	-3 & -4 DIA.		-5, -6 & -8 DIA.		L MAX	K MAX	L MAX	K MAX	L MAX	K MAX	L MAX	K MAX	L MAX	K MAX
	MIN	MAX	MIN	MAX										
-01	.015	.062	.015	.062	.140	.218	.170	.256	④.211	.380	③④.239	.420	---	---
-02	.063	.125	②	.125	.203	.281	.232	.318	.274	.440	.301	.480	③.342	.520
-03	.126	.187	.126	.187	.265	.343	.295	.381	④.336	.500	④.363	.540	④.405	.585
-04	.188	.250	.126	.250	.328	.405	.357	.443	.399	.560	.426	.600	.447	.650
-05	.251	.312	.251	.312	④.390	.468	.420	.506	④.462	.625	④.489	.660	④.510	.710
-06	.313	.375	.251	.375	④.453	.530	.482	.568	.524	.690	.551	.720	.572	.770
-07	.376	.437	.376	.437	---	---	.544	.630	④.602	.750	④.613	.780	④.635	.830
-08	.438	.500	.376	.500	---	---	.607	.693	.679	.810	.706	.840	.697	.890
-09	---	---	.501	.562	---	---	---	---	---	---	④.753	.905	④.760	.955
-10	---	---	.501	.625	---	---	---	---	---	---	.801	.970	.822	1.020
-11	---	---	.626	.687	---	---	---	---	---	---	④.864	1.035	④.885	1.085
-12	---	---	.626	.750	---	---	---	---	---	---	.926	1.100	.947	1.150
-13	---	---	.751	.812	---	---	---	---	---	---	④.989	1.160	④.1.010	1.210
-14	---	---	.751	.875	---	---	---	---	---	---	1.051	1.220	1.072	1.270
-15	---	---	.876	.937	---	---	---	---	---	---	---	---	④.1.134	1.335
-16	---	---	.876	1.000	---	---	---	---	---	---	---	---	1.195	1.400

SHEET 2 OF 3

PART NUMBER

ISSUE

12-30-77

REV.

AA

5-14-15

CR9117



NOTES:

- ① MATERIAL DESIGNATION REFERS TO CHEMICAL COMPOSITION ONLY.
- ② MINIMUM GRIP FOR -5 DIAMETER IS .015; FOR -6 DIAMETER IS .015; FOR -8 DIAMETER IS .063.
- ③ SPECIAL ORDER ONLY.
- ④ THESE GRIPS NOT LISTED ON NASM20604 DRAWING.
- 5. LUBE MAY BE ADDED AS REQUIRED FOR PERFORMANCE.
- ⑥ "PR" CODE PARTS ARE MANUFACTURED BARE; IF LUBE IS REQUIRED, USE PAR 90 ONLY.
- ⑦ FINISH CODES WITH THE PREFIX "G" INDICATE REACH COMPLIANT COATING.

EXAMPLE OF CHERRY PART NUMBER:

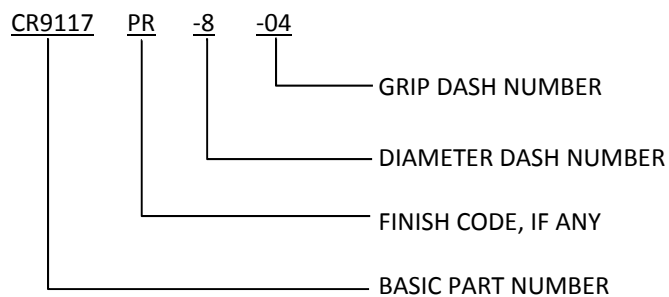

SHEET 3 OF 3			PART NUMBER
ISSUE	12-30-77		CR9117
REV.	AA	5-14-15	

STANDARDS PAGE REVISION LOG CR9117

REV LTR	DATE	DCR NUMBER	REVISION DESCRIPTION	COMP. BY
AA	14 May 15	14-1283	<ul style="list-style-type: none">• ADDED REACH COMPLIANT COATING G, GPR• ADDED NOTE 7• GENERAL CLEANUP AND STANDARDIZATION	CL